

**MULTI-BOLT™**

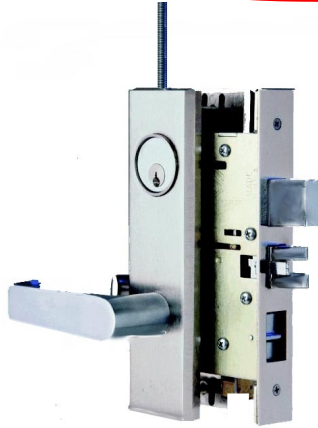

**INTERIOR TRIM**



**EXTERIOR TRIM**

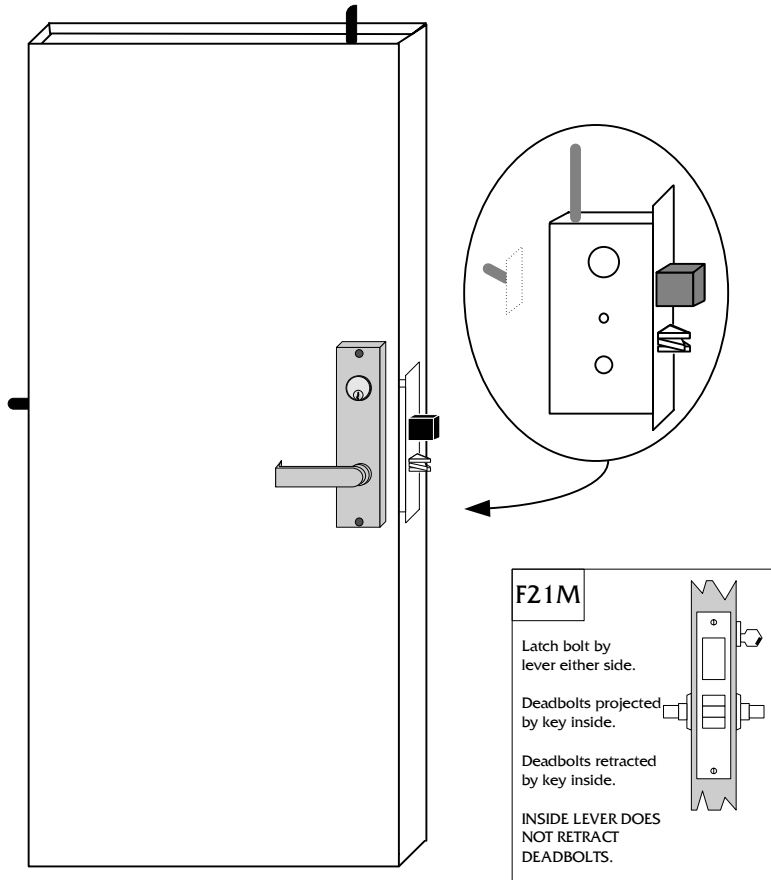

**INTERIOR VIEW**

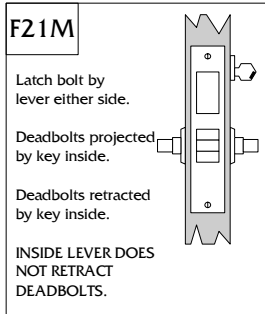

**Prevents Break-Ins**

**Restricts Children's Access To Balcony**

- Special Function For Apartment House Balcony Doors
- Deadbolts Can Only Be Locked Or Unlocked By Interior Cylinder
- 3-Point Locking; Primary, Top And Hinge-Side Deadbolts
- Stationary Bolt On Hinge Side Of Door
- Accepts 1 1/4" Length Mortise Cylinders Of All Manufacturers
- Custom Exterior Trim With Five Thru-Bolts
- Custom Interior Trim With Cylinder Operation & Two Thru-Bolts
- Rotating Key Locks Or Un-Locks All The Deadbolts
- Fits Into Standard Mortise Openings
- Exterior Lever Contains "LeverEx" Slip-Clutch System

**DOOR PREPARATION:**

Vertically-Stiffened Hollow Metal Recommended. 1 1/4 X 8" Mortise Opening. U-Channels On Top & Bottom For Elevated Edge Plates. Hinge-Side Bolt Is Not Connected To The Lock Mechanism.

**FRAME PREPARATION:**

4 7/8" Strike Standard. Dustproof Strike Standard. Strike Holes In Header & Hinge Side To Be Field-Drilled & Strike Plates Are Not Required.

**HANDING:**

Order LH, RH, LHR Or RHR

**MODEL NUMBER**

**#5357-F21M** With Features Listed Above

See page D5 for complete ordering information