

Hole Number: Hole Size (dia.)

- 1) Knob / Lever 1"
- 2) Mounting Posts 3/8"
- 3) Outside Cylinder 1-3/8"
- 4) Thumbturn 3/4"
- 5) Escutcheon Bolts 7/16"

Note: for top & bottom rods holes see template #5XXXDB

FLAT TO 1/8" IN 2" FRONT BEVEL

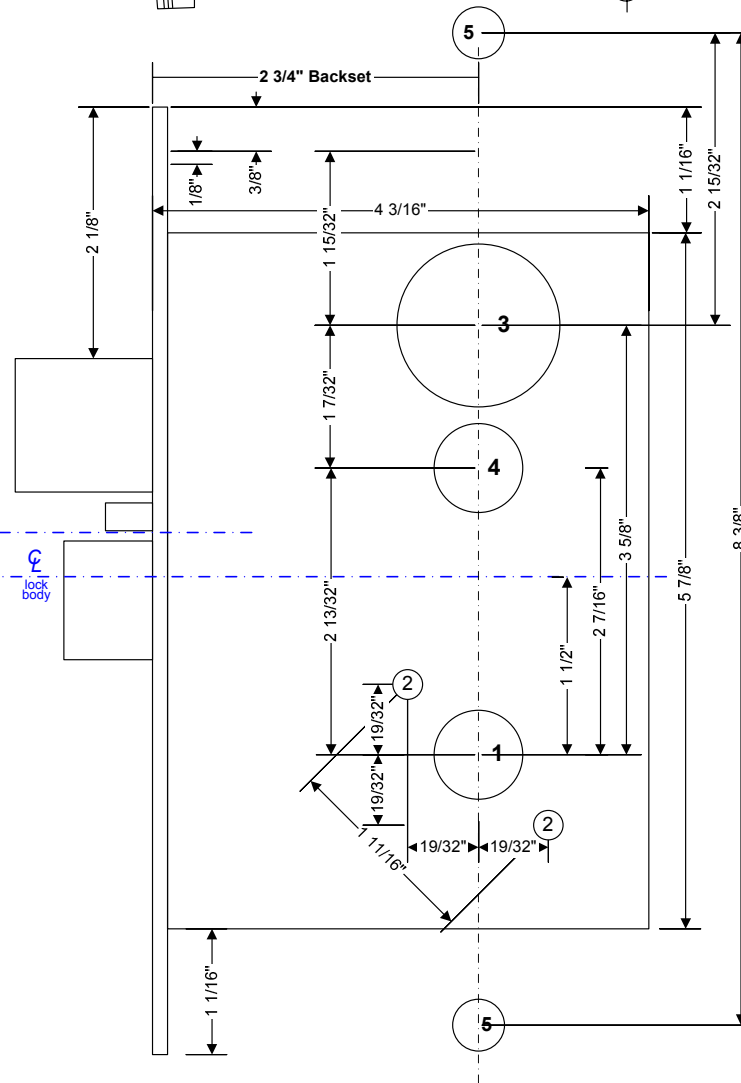
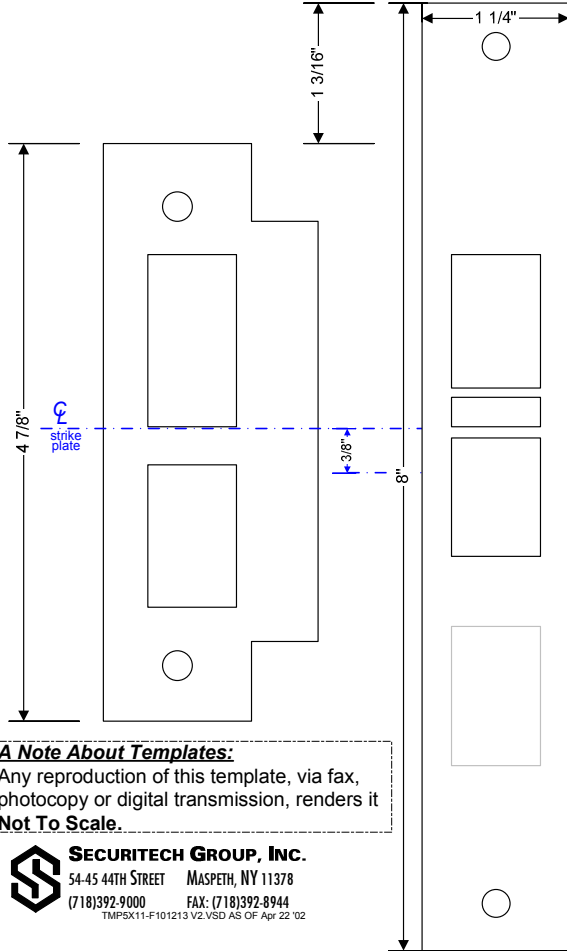
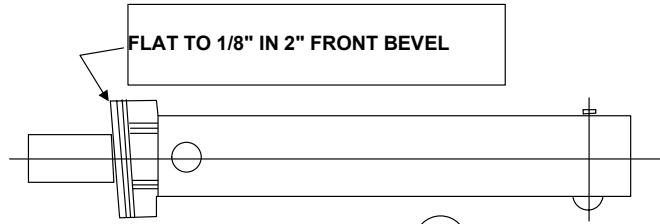

**SECURITECH™**  
**TEMPLATE #5X11**  
 FOR USE WITH MODEL # 5X11  
 FUNCTIONS: F13, F10, F12

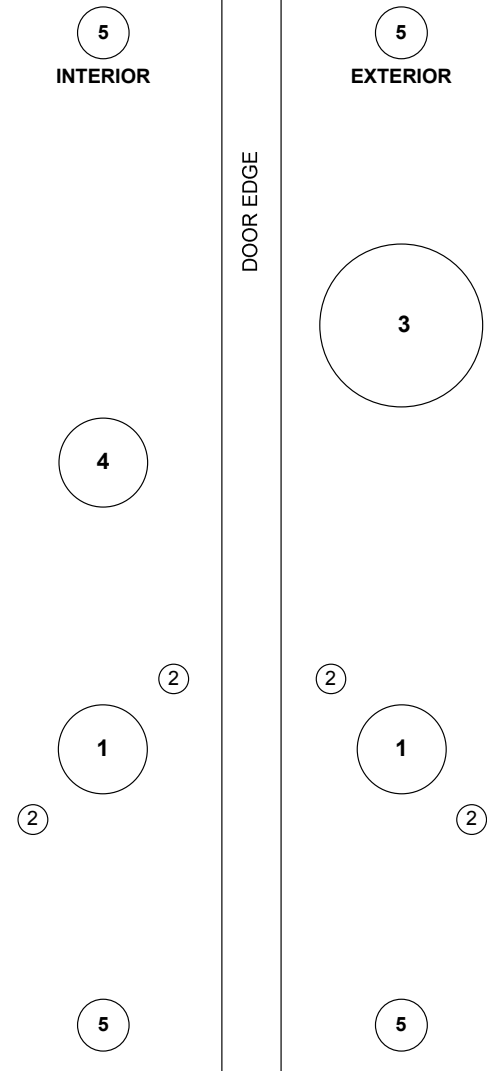

**A Note About Templates:**  
 Any reproduction of this template, via fax, photocopy or digital transmission, renders it **Not To Scale.**

**SECURITECH GROUP, INC.**  
 54-45 44TH STREET MASPETH, NY 11378  
 (718)392-9000 FAX: (718)392-8944  
TMP5X11-F101213 V2.VSD AS OF Apr 22 '02